

# 4 Appearance

## 4.5 Illustrative Views: View from Shoreditch Park



# 4 Appearance

## 4.5 Illustrative Views: View from Northport Street

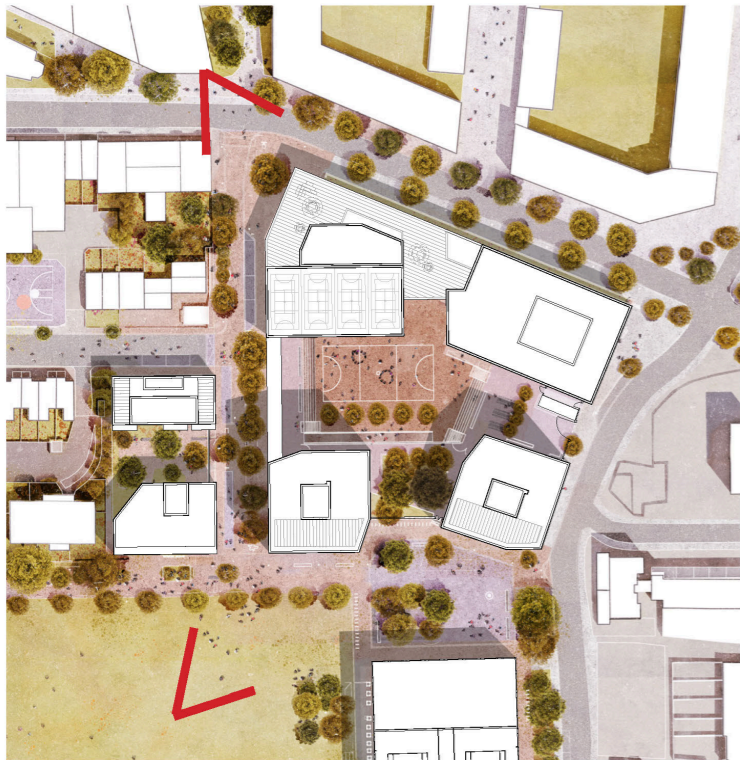

# 4 Appearance

## 4.5 Illustrative Views: View from Northport Street



# 4 Appearance

## 4.6 Ground Floor Glazing and Signage Approach

Commercial frontages are provided along Grange Street and Northport Street for H4. The commercial frontage within H6 is located along Pitfield Street and returns to address the Square.

### Signage Approach:

Signage will be controlled to the zone identified in the images across the development to ensure the signage strategy is consistent. The sign will be suspended behind the glazing.

This will be coordinated to the building glazing module or above the entrance doors

The facades to the commercial units, above the glazing, also have a metal perforated zone for services, this language of perforated metal panels is repeated on the residential facades to accommodate the servicing strategy for the building.



H3 Grange Road Elevation:



H5 Grange Road Elevation:



H6 Pitfield Street Elevation: